

TERRA-TEC

invatec
Always an *innovation* ahead

Solid designated/authorised walkway
EASILY ACHIEVED.

When heavy things are meant to stay solid, there is an easy way to achieve this.

Until recently heavy concrete slabs (approx. 90 kg/slab) have been used for the construction of designated/authorised walkways and ballast mountings in building measures of world wide rail industries. Rails, T-beams, double-T-beams or round pipes are used for the support construction of the concrete slabs; these are rammed into the ground without any structural analysis. Afterwards the concrete slabs are laid into the support structure. The railway line must be closed, in order to construct these ballast mountings and designated/authorised walkway constructions.

This construction method bears the additional risk, that the concrete slabs might be hit by the excavator shovel during the levelling of the ballast and break. In this case the ballast which has already been filled in must be removed again, in order to be able to exchange the broken concrete slab.

Today there are new materials making it possible to avoid the problems described above: The designated/authorised walkway construction **TERRA-TEC** by invatec is a panel made of glass fibre reinforced plastic. The simple installation and the light weight products result in economic advantages. HEB 100 double-T-steel profiles are used as support structure into which the glass fibre reinforced plastic panels are laid. The railway line does not need to be shut down.

The system **TERRA-TEC** offers a significant variety of applications such as retention of ballast, designated/authorised walkway construction, stabilisation of embankments, work place construction around signals and revision locations, installation of switch points ...
invatec - always one innovation ahead!



Technical specifications

Material: glass fibre reinforced plastic panel with glass fibre rovings and mats as well as surface mats of fibres to improve environment resistance
 Dimensions: 2,000 x 250 x 50 mm
 Weight / m: 4.65 kg

Fire protection classification: K1 (DIN 53438 part 2)
 Fire behaviour: B-s2,d0 (DIN EN 13501-1)
 Production control according to DIN 13706
 Developed according to DBS 918 010 (gratings and construction profiles made of glass fibre reinforced plastic in constructive engineering)
 DB guideline 836.4304 (cycle path constructions)

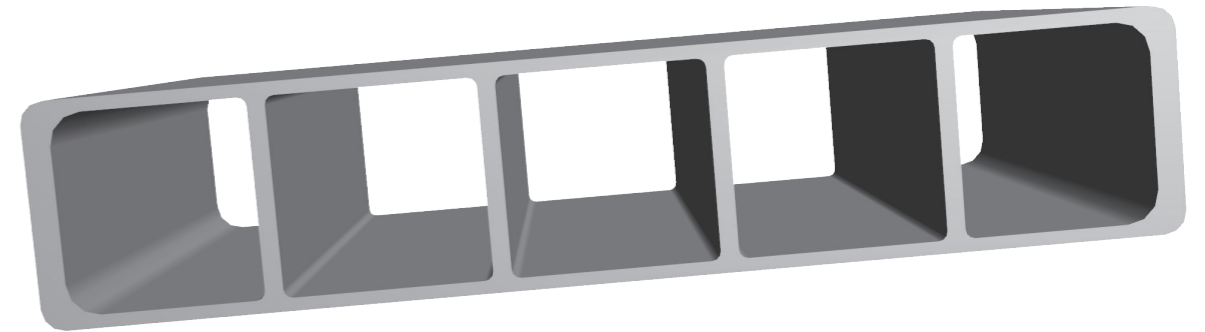

The advantages in summary

- solid construction (TÜV Rheinland LGA Bautechnik – structural analysis / design calculation check as well as laboratory verifications available)
- low weight (approx. 10 % compared to concrete)
- no shutdown of line required
- high installation performance
- high economic efficiency
- quick and ergonomic installation
- the required support can be installed by means of a hand pile-driver
- process reliability thanks to standards, highest production requirements and quality controls according to DIN EN 13706
- standard proof of safety and audited structural analysis up to a height of 50 cm



invatec
Always an **innovation** ahead

invatec GmbH

Dieselstr. 21
74589 Satteldorf – Germany

P +49 7951 29641-0
F +49 7951 29642-11

info@invatec-gmbh.de
www.invatec-gmbh.de

